

**Two Postdoctoral Positions in Vienna  
Immunology, Genetics, Precision medicine**

Closing date for applications: March 31, 2018

Expected starting date: May 1, 2018

We are seeking two motivated postdoctoral scientists to join the research groups of Kaan Boztug and Loïc Dupré at the Ludwig Boltzmann Institute for Rare and Undiagnosed Diseases (LBI-RUD) and CeMM Research Center for Molecular Medicine of the Austrian Academy of Sciences in Vienna, Austria.

Most inborn errors of the immune system are caused by single-gene defects and thereby offer unique opportunities to decipher fundamental regulatory pathways of the human immune system. The focus of our groups which work in close collaboration is to understand the disease-causing molecular mechanisms in PID patients and to develop targeted diagnostic and therapeutic options.

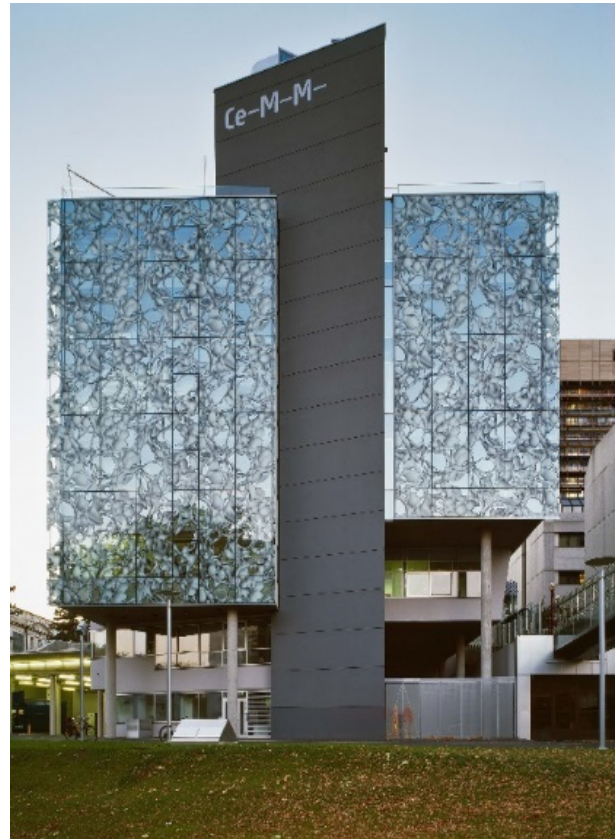

**The Research Groups**

**Kaan Boztug** is a leading immunologist and rare diseases researcher and director of the newly founded Ludwig Boltzmann Institute for Rare and Undiagnosed Diseases (LBI-RUD). His projects successfully combine state-of-the-art genomic technologies, cellular and molecular approaches and network biology to discover novel disease etiologies underlying PIDs (Ozen et al., *NEJM* 2017; Salzer et al., *Nat Immunol* 2016; Dobbs et al., *NEJM* 2015). This project aims at combining high-throughput genomics, dissection of molecular mechanisms, and network biology to prioritize and contextualize immunodeficiency genes, to uncover molecular clusters of immune disorders and their relationship to more common diseases.

**Loïc Dupré** is an expert on cytoskeleton regulation and quantitative imaging of human lymphocytes (Houmadi et al., *Cell Rep* 2018; Pfajfer et al., *Blood* 2017; Malet-Engra et al., *Curr Biol* 2015) who aims at implementing innovative high-content cell imaging assays to systematically identify and dissect lymphocyte defects in immunodeficiency patients. Cellular signatures will be integrated into molecular networks to further enhance identification of novel immunodeficiency-causing gene defects and to yield maps of the molecular networks controlling fundamental aspects of human lymphocyte biology.

The **Boztug** and **Dupré** labs will work jointly using the aforementioned molecular and systems biology approaches to engineer drug screens (together with **Stefan Kubicek**, CeMM) for

development of rational, targeted therapeutic interventions. In addition both projects are closely interconnected to the laboratory of **Jörg Menche** (CeMM), who will provide expertise in the integration of complex datasets derived from post-genomic technologies through the lens of network science (Menche et al., *Science* 2015).

### **Your Requirements & Application**

You should be a proactive person and an independent thinker with a strong background in one or more of the following disciplines: **Immunology, Genetics, Medicine or Molecular Biology**. To apply for a postdoctoral position at our organization you need to hold a PhD (respectively DVM/MD or equivalent) degree or you should be in the final phase of your PhD studies. To complement our international, open-minded team, you should ideally be a dedicated scientist and team player with excellent communication skills and a very good command of English. Enthusiasm, work ethics, creativity as well as a proactive approach to solving problems and developing new ideas are highly desirable. We are looking for candidates who are able to connect different scientific disciplines and think outside the box.

**The Institute - LBI-RUD** ([www.rare-diseases.at](http://www.rare-diseases.at)) is located, embedded and integrated into **CeMM**, a flagship institute for biomedical research in Vienna with the highest scientific standards as exemplified by recent publications in top journals including *Nature*, *Science* and *Cell* and ERC grants attributed to Kaan Boztug and Principal Investigator Christoph Bock. Our research center is strategically located next to one of the world's largest university hospitals in the heart of the city in a beautiful building with outstanding design, state-of-the-art laboratories and technology platforms. The studies will be carried out in fully equipped molecular biology laboratories in a shared environment with cell culture and multi-color flow cytometry. All equipment needed for state-of-the art genomic investigations such as SNP arrays and deep sequencing are immediately accessible in the building. The groups are embedded in a multidisciplinary and highly collaborative systems biology/molecular medicine research environment providing access to state-of-the-art mass spectrometry, bioinformatics, automated chemical biological screening platform and animal facilities, including BSL2 suites. The strategic partnership of LBI-RUD with its renowned partner institutions CeMM, the Children's Cancer Research Institute of the St. Anna Children's Hospital and the Medical University of Vienna provides an excellent environment for top level translational research in leading research groups.

---

### **Why you want to join our team:**

- ✓ You want to pursue meaningful research at the highest level in an inspiring and international working environment.
- ✓ You want to be part of the next generation of scientists who shape the future of medicine and value our numerous possibilities for personal and professional growth.
- ✓ You appreciate our young and dynamic working atmosphere and the possibility to join our cultural, social and sports activities.
- ✓ You appreciate the help and assistance we offer to all our employees, their spouses and family members in terms of visa and relocation procedures, dual-career and childcare services, and others.

- ✓ You wish to receive a competitive salary: your position will be remunerated according to FWF personnel costs (<https://www.fwf.ac.at/en/research-funding/personnel-costs/>) depending on qualifications and experience.

**Why we want you to join our team:**

- ✓ You are a proactive and independent thinker with a strong background in Immunology, Genetics, Cellular and Molecular Biology, Cell imaging, Bioinformatics, Systems or Network Biology, or similar.
- ✓ You are enthusiastic and passionate about science.
- ✓ You are motivated to find innovative, creative and free-spirited solutions to open research questions.
- ✓ You love to communicate, to collaborate, to connect different scientific disciplines and to contribute to multidisciplinary and multicultural teams.

**Application Details**

Please apply with a cover letter describing your career goals and explaining why you are the ideal candidate for this position, your detailed CV and contact details of 2-3 referees. Please indicate in your cover letter which lab you would preferably like to join and send your full application in one single PDF file to: [application@rud.lbg.ac.at](mailto:application@rud.lbg.ac.at) (using the reference code **#LBIPD2018**) or upload your application documents here <https://cemm.jobbase.io/job/t68duwi9>

Initial application deadline is March 31, 2018, but applications will be reviewed on a rolling basis and the call will remain open until the position is filled.